

Sanitary Pumps Type F 560 S Version with bearing flange

Recommended for transferring

Thin to highly viscous, even pasty, still free flowing substances.

Typical applications

A pump designed to meet the specific requirements of the food, cosmetic and pharmaceutical industries.

The sanitary pump type F 560 S can be stripped down in no time for cleaning and/or sterilisation. The stator housing comprises a safety bar to protect containers and to allow transfer operations from plastic liners.

The F 560 S pump is available in special version with 3A approval: ground and polished, equipped with a closed mechanical seal in stainless steel with sliding faces in silicium carbide (SiC).

Available drive motors

Three-phase electric motors or compressed air motors

Scope of supply

A complete eccentric worm-drive pump consists of: drive motor, pump, stator and hose connection.

The type XA is delivered with stator.

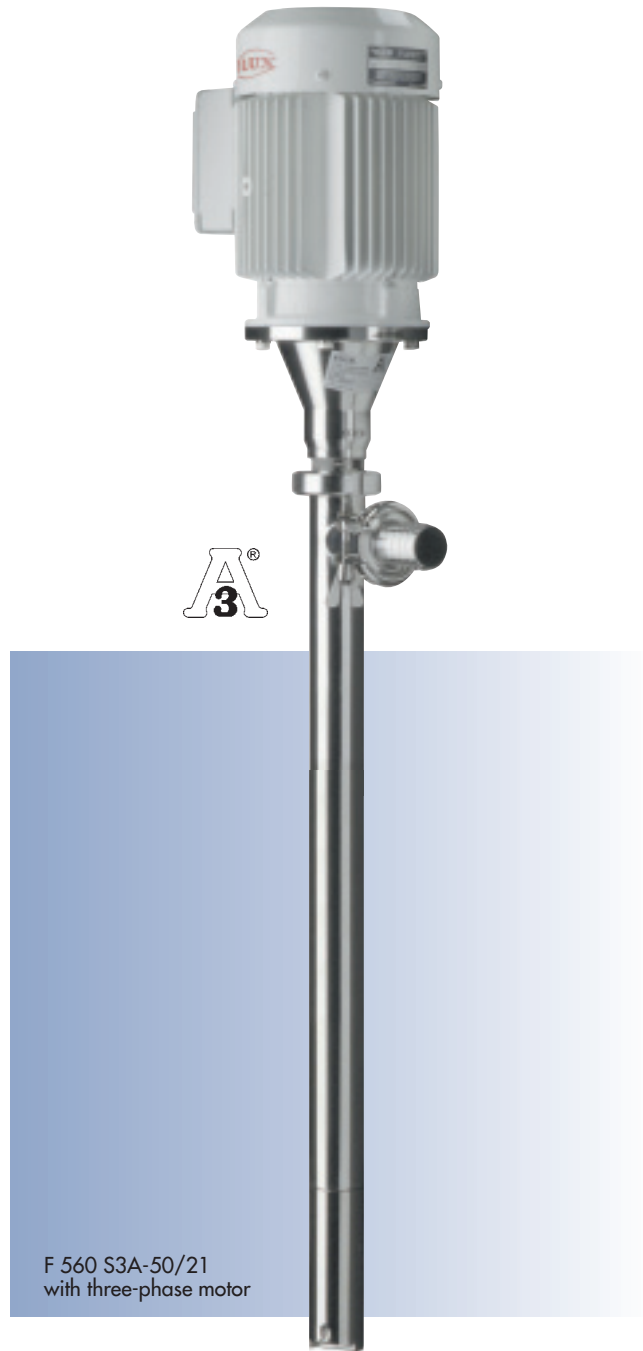



Technical Data

Type	Viscosity mPas (cP)	Curve No.	Performance Chart
F 560 S1-50/21	1	1	
F 560 S2-50/21	1.000 – 2.000	2	
F 560 S3A-50/21	20.000 – 25.000	3	
F 560 S1-54/26	1	4	
F 560 S2-54/26	1.000 – 2.000	5	
F 560 S3A-54/26	20.000 – 25.000	6	

With higher viscosities delivery rate will be lower, depending on the velocity of the fluid.



Values \pm 10% at 930 rpm. Delivery rate depends on the velocity of the fluid.

Eccentric Worm-Drive Pump with mechanical seal in bearing flange version, drive motors see page 16

Type	F 560 S1-50/21	F 560 S2-50/21	F 560 S1XA-50/21	F 560 S2XA-50/21
Delivery rate max.	30 l/min	30 l/min	30 l/min	30 l/min
Delivery head max.	8 bar	8 bar	8 bar	8 bar
Thread on outlet	Rd 58 x 1/6	G 1½ A (BSP 1½" male)	Rd 58 x 1/6	G 1½ A (BSP 1½" male)
Seal type	mechanical seal in SiC, o-rings in FKM (foodgrade)			
Material	bearing flange, outer tube, torsion shaft and eccentric worm in stainless steel 316 Ti			
Outer-Ø	50 mm	50 mm	50 mm	50 mm
Stator	not included with the pump, separate part number please see list below		Stator PTFE white, included with the pump	
Explosion-proof according to ATEX-Directive 94/9/EC	not approved for transferring high flammability liquids in Zone 0		EC Type Examination Certificate No. PTB 99 ATEX 4050 X (Ex II 1/2 G IIA T4)	
Part No./Weight				
Immersion length 27"	560 20 007/12.8 lbs	560 20 107/12.8 lbs	– 	– 
Immersion length 39"	560 20 010/14.3 lbs	560 20 110/14.3 lbs	560 20 810/15.6 lbs	560 20 910/15.6 lbs
Immersion length 47"	560 20 012/15.4 lbs	560 20 112/15.4 lbs	560 20 812/16.7 lbs	560 20 912/16.7 lbs

Type	F 560 S1-54/26	F 560 S2-54/26	F 560 S3-54/26
Delivery rate max.	50 l/min	50 l/min	50 l/min
Delivery head max.	8 bar	8 bar	8 bar
Thread on outlet	Rd 58 x 1/6	G 1½ A (BSP 1½" male)	Clamp 2"
Seal type	mechanical seal in SiC, o-rings in FKM (foodgrade)		
Material	bearing flange, outer tube, torsion shaft and eccentric worm in stainless steel 316 Ti		
Outer-Ø	54 mm	54 mm	54 mm
Stator	not included with the pump, separate part number please see list below		
Part No./Weight			
Immersion length 27"	560 22 007/13.9 lbs	560 22 107/13.9 lbs	560 22 207/13.9 lbs
Immersion length 39"	560 22 010/15.4 lbs	560 22 110/15.4 lbs	560 22 210/15.4 lbs
Immersion length 47"	560 22 012/16.5 lbs	560 22 112/16.5 lbs	560 22 212/16.5 lbs

Eccentric Worm-Drive Pumps Type F 560 S3A in 3A version

Type	F 560 S3A-50/21	F 560 S3A-54/26
Delivery rate max.	30 l/min	50 l/min
Delivery head max.	8 bar	8 bar
Thread on outlet	Clamp 2" 	Clamp 2" 
Seal type	closed mechanical seal in stainless steel, sliding faces in SiC, O-rings in FKM (foodgrade)	
Material	bearing flange, outer tube, torsion shaft and eccentric worm in stainless steel 316 Ti, ground and polished	
Outer-Ø	50 mm	54 mm
Stator	stator in PTFE included with the pump	
Part No./Weight		
Immersion length 27"	560 24 007/12.8 lbs	560 25 007/13.9 lbs
Immersion length 39"	560 24 010/14.3 lbs	560 25 010/15.4 lbs
Immersion length 47"	560 24 012/15.4 lbs	560 25 012/16.5 lbs

Stator in PTFE, Stator Housing in Stainless Steel with Safety Bar

Type F 560 S1, S2 and S3	Part No./Weight
Outer-Ø 50 mm	560 21 900/1.32 lbs
Outer-Ø 54 mm	560 23 900/1.5 lbs

Hose Connection in Stainless Steel, complete with Union Nut or Clamp Connection

Part No./Weight	Type F 560 S1	Type F 560 S2	Type F 560 S3 and S3A
for flexible hose, inside 1" ID	959 04 115/0.4 lbs	959 04 002/0.4 lbs	–
for flexible hose, inside 1¼" ID	959 04 134/0.7 lbs	959 04 003/0.7 lbs	959 04 137/0.9 lbs
for flexible hose, inside 1½" ID	959 04 130/0.9 lbs	959 04 004/0.9 lbs	959 04 109/0.9 lbs

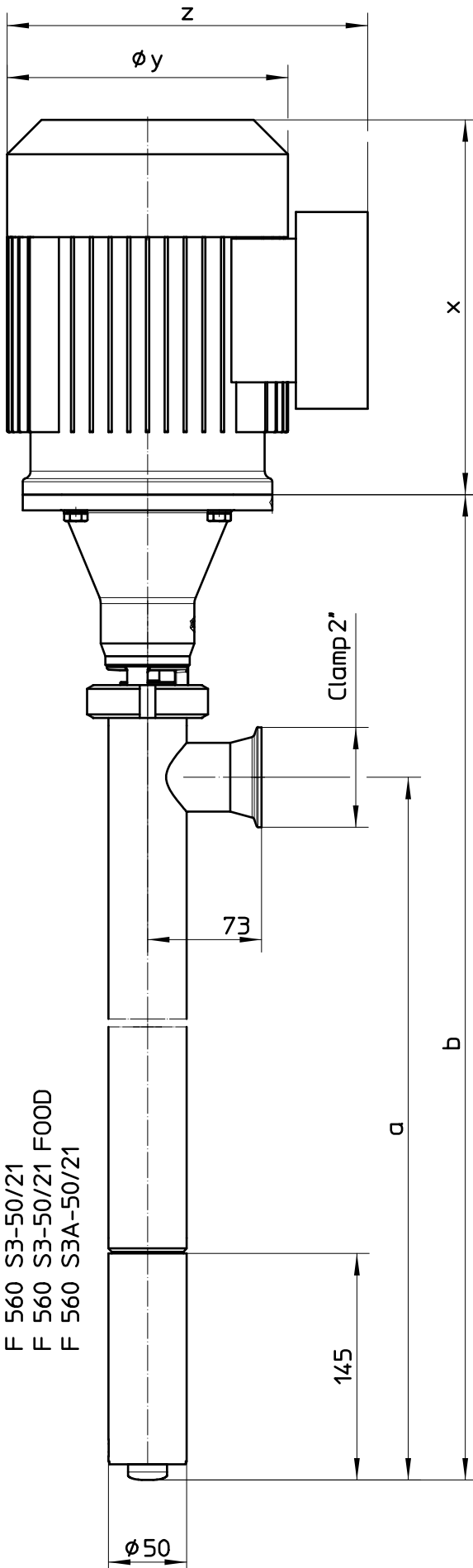

Motor Moteur		kW
n=		min ⁻¹
x=		mm
Øy=		mm
z=		mm
ET=		mm

1500	1515	1696
1200	1215	1396
1000	1015	1196
700	715	896
ET	a	b

ET=Eintauchtiefe
 Immersion length
 Longueur d'immersion

F 560 S3-50/21
 F 560 S3-50/21 FOOD
 F 560 S3A-50/21

F 560 S2-50/21

F 560 S1-50/21

G1 1/2A

Rd58x1/6

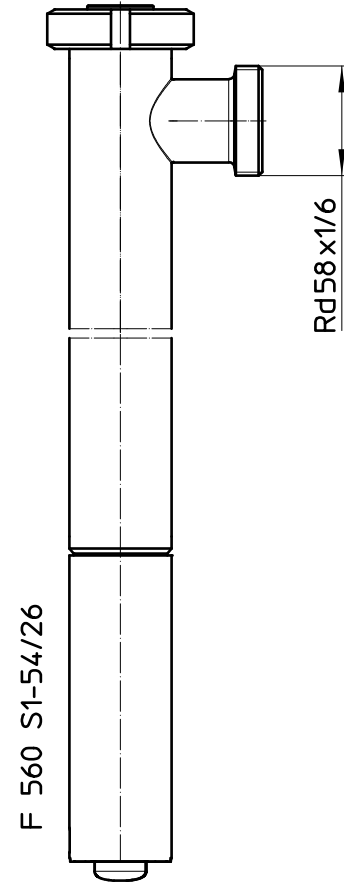
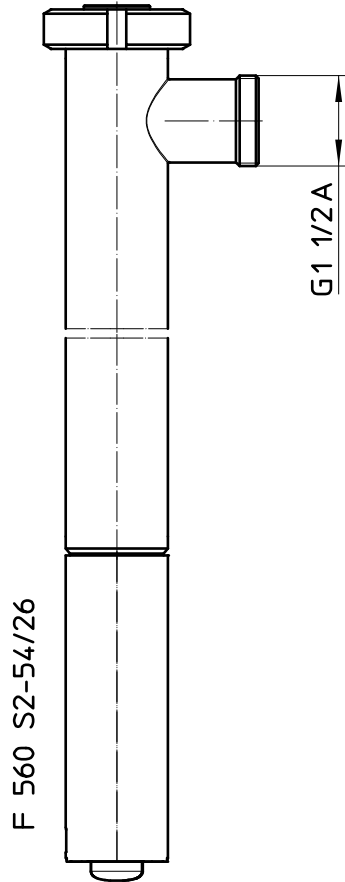
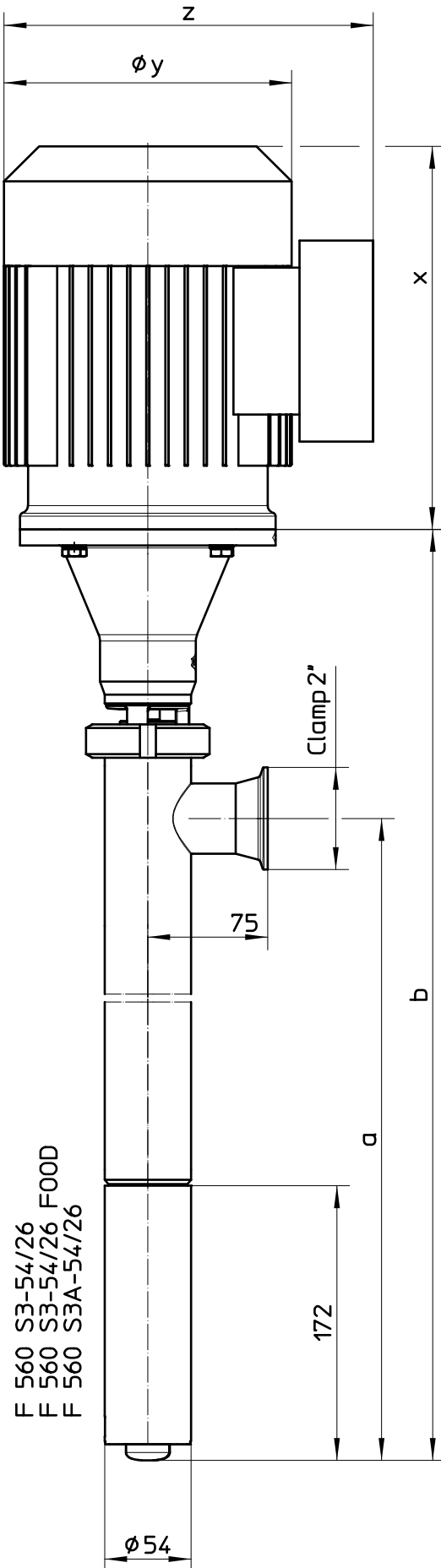

Motor Moteur		kW
n=		min ⁻¹
x=		mm
φy=		mm
z=		mm
ET=		mm

1500	1542	1723
1200	1242	1423
1000	1042	1223
700	742	923
ET	a	b

ET=Eintauchtiefe
Immersion length
Longueur d'immersion

Drive Motors for Eccentric Worm-Drive Pumps

Drive Motors for Eccentric Worm-Drive Pumps Type F 550 and F 560* version with bearing flange



E3ph
Three-phase motor



Compressed air motor

Three-phase motors 230/400 Volt, 60 Hz, with motor protection switch, without cable

Capacity	Speed	jet-proof to	max. Viscosity	Part No./Weight
1.1 kW	840 rpm	IP 55	25.000 mPas (cP)	001 02 127/27.6 lbs

Compressed air motors, max. operating pressure 7 bar, explosion-proof to II 2 G cT5

Type	Capacity	Speed at 6 bar	Connection	max. Viscosity	Part No./Weight
G22B	0,5 kW	1000 rpm	G 3/8 (BSP 3/8" female)	25.000 mPas (cP)	001 04 000/11.0 lbs
G11A	1,1 kW	1000 rpm	G 1/2 (BSP 1/2" female)	50.000 mPas (cP)	001 04 014/15.4 lbs
G28A	1,8 kW	1000 rpm	G 1/2 (BSP 1/2" female)	pasty	001 04 002/22.0 lbs